

Manual Torque Multiplier Standard Series

Technical Specifications

Standard series manual multipliers apply a torque 5, 25 or 125 times greater than that set by the torque wrench which drives the multiplier. This means a dramatic reduction in lever length and the operator effort.

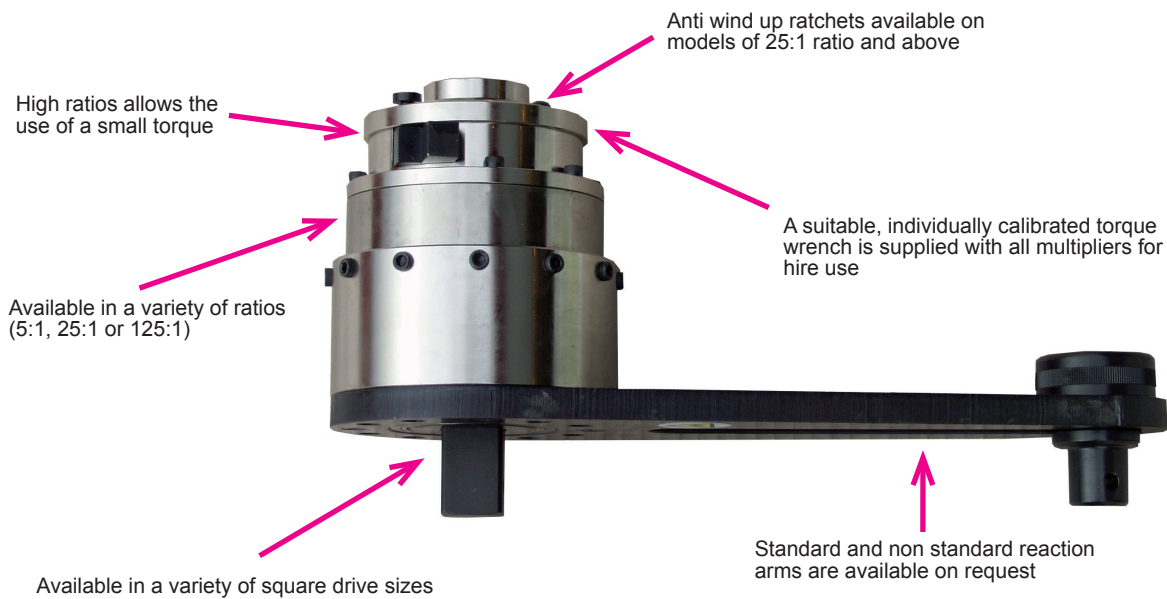

Model	Part Code	Range		Ratio	Input Square	Output Square	A	B	C	D	Tool Weight	Reaction Weight
		Nm	lbf.ft		in	in	mm	mm	mm	mm	kg	kg
1	16010	1700	1250	5:1	1/2"	3/4"	108	106	83	217	3	2.2
2/5	16012	1700	1250	5:1	3/4"	1"	108	126	83	217	3	2.2
2/25	16089	1700	1250	25:1	1/2"	1"	108	156	83	217	5.6	2.2
5/5	16014	3400	2500	5:1	3/4"	1"	119	143	86	264	4.7	2.5
5/25	16090	3400	2500	25:1	1/2"	1"	119	187	86	264	7.5	2.5
6/5	16016	3400	2500	5:1	3/4"	1-1/2"	119	149	86	264	4.7	2.5
6/25	16092	3400	2500	25:1	1/2"	1-1/2"	119	195	86	264	7.5	2.5
7/5	16067	6000	4500	5:1	3/4"	1-1/2"	144	165	146	333	8.1	6.3
7/25	16065	6000	4500	25:1	1/2"	1-1/2"	144	225.5	146	333	10.7	6.3
7/125	16068	6000	4500	125:1	1/2"	1-1/2"	144	239.5	146	333	12.2	6.3
9/25	16070	9500	7000	25:1	3/4"	1-1/2"	184	209	171	351	17.4	8.3
9/125	16071	9500	7000	125:1	1/2"	1-1/2"	184	234	171	351	18.9	8.3
11/25	16048	20000	14700	25:1	3/4"	2-1/2"	212	329.4	x	500	30.6	13.3
11/125	16049	20000	14700	125:1	1/2"	2-1/2"	212	307	x	500	32.1	13.3
13/125	16053	47500	35000	125:1	3/4"	2-1/2"	315	366	x	x	95.2	6.9

Multipliers available to buy or hire

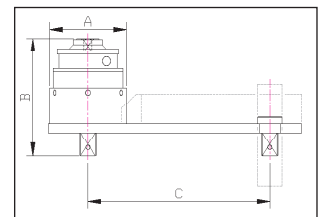

Illustration shown with a standard flat reaction and sliding slave drive. Larger models are supplied with box section reaction plate and sliding foot.

*** AWUR on Models 25:1 & 125:1 ratio**

• No statement or data within this literature is warranted or guaranteed to be accurate.

Whilst every effort has been made to ensure the availability of the models and specifications within this catalogue, our policy of continuous improvement means specifications and models are liable to change without notice. We reserve the right to change the specifications and models available for sale or hire and to supply equivalent products where appropriate.

W.CHRISTIE (INDUSTRIAL) LTD
 CHRISTIE HOUSE, MEADOWBANK ROAD,
 ROTHERHAM, SOUTH YORKSHIRE, S61 2NF, UK
 T : +44(0)1709 550088 F : +44(0)1709 550030
 E : INFO@WCHRISTIE.COM W : WWW.WCHRISTIE.COM

REGISTERED OFFICE: UNIT F7, FESTIVAL BUSINESS CENTRE,
 150 BRAND STREET, GLASGOW, G51 1DH SCOTLAND
 T: +44(0)141 427 9801 F: +44(0)141 427 9802
 E: WCHRISTIEGLW@BTCONNECT.COM
 REGISTRATION NO: SC 035247



CERTIFICATE NO: 2539/00