

# Rundown Fixture

## Technical Specifications

The Christie Rundown Assemblies are designed to simulate the working conditions of screwed or bolted joints. Supplied with a static transducer and used in conjunction with the TTT readout, the Rundown Assembly is used for non-impacting power tool testing and calibration. For intermittent or short term use, the Rundown Assembly can be supplied on a hire basis.

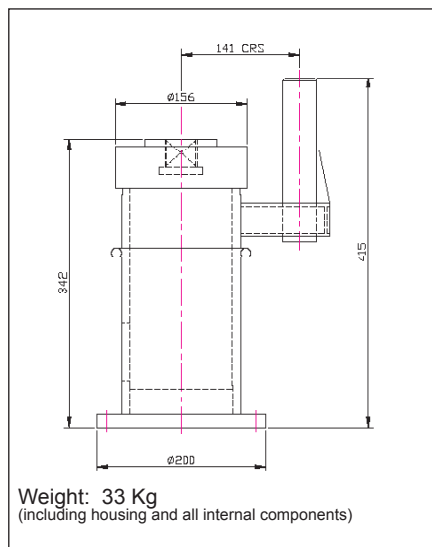
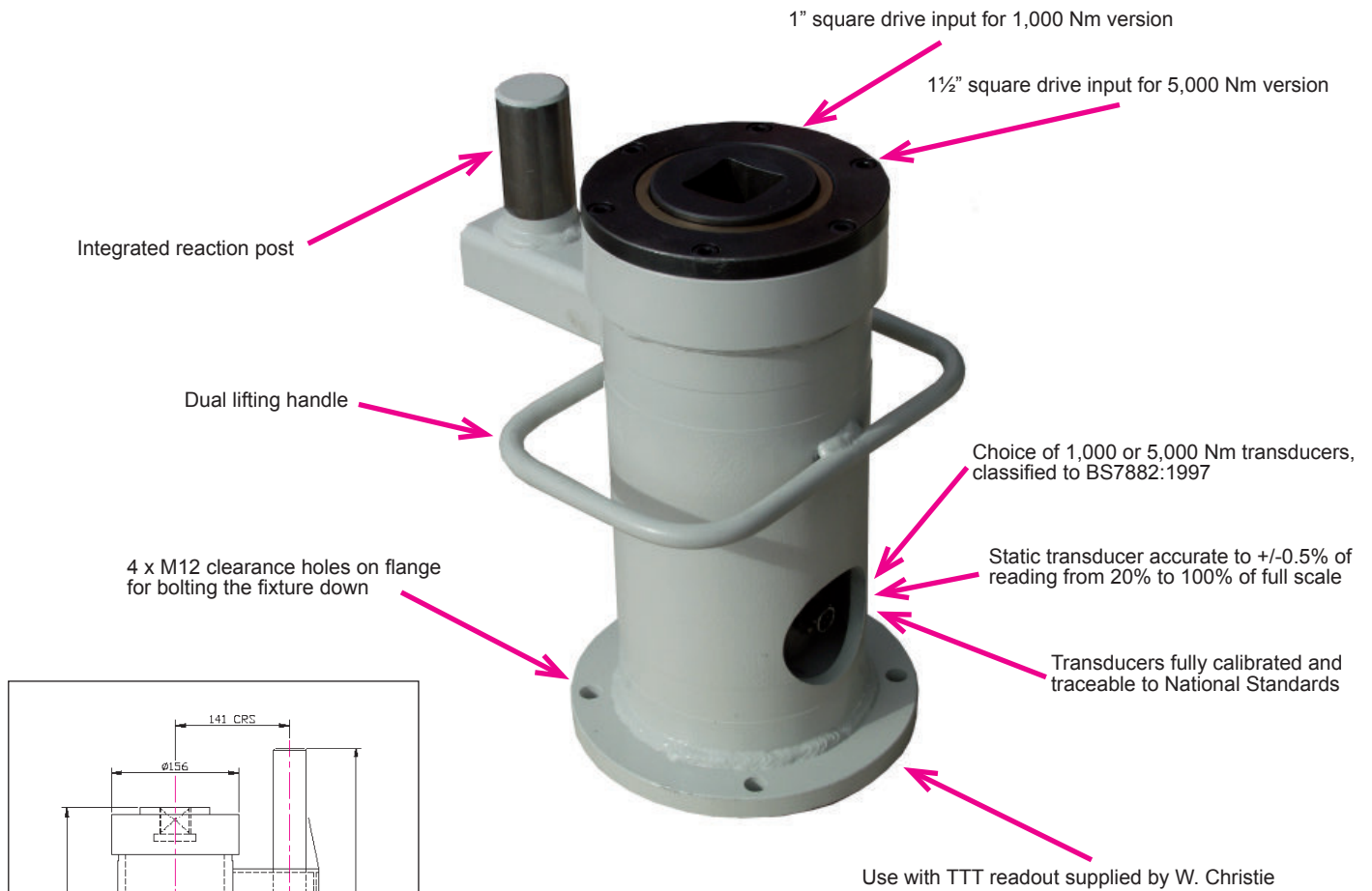

Rundown fixture assemblies are available for sale or hire complete with:

- Steel constructed housing
- Dual lifting handle
- Integrated reaction post
- 1,000 or 5,000 Nm static transducer classified to BS7882:1997
- Calibration certification for transducer, traceable to National Standards
- Threaded joint for bolt simulation
- Transducer cable to link to TTT readout

• No statement or data within this literature is warranted or guaranteed to be accurate.

Whilst every effort has been made to ensure the availability of the models and specifications within this catalogue, our policy of continuous improvement means specifications and models are liable to change without notice. We reserve the right to change the specifications and models available for sale or hire and to supply equivalent products where appropriate.