



# Smart Socket

**SMART SOCKET**

The W. Christie Smart Socket transducer is the convenient and flexible way to check the torque on critical bolting applications where full data traceability is required.

- Easy to fit – simple 'o' ring and retaining pin fixture
- Accuracy of +/-2%
- Compact design – no larger than a standard socket
- Powered by internal rechargeable Lithium battery (supplied)
- Easy to read Smart Socket display, with:
  - max. applied torque
  - switchable units of torque (Nm or lbf.ft)
  - 'pass' or 'fail' display - tolerance (%) and target figure for torque set via software
  - storage of up to 750 results
- Automatic standby facility and low battery warning
- Supplied with Windows compatible software:
  - available for use on additional PCs
  - store data as CSV. or Excel
  - store multiple data logs
- Charge via the netbook or by USB mains adaptor (both not supplied as part of standard set)



For use on any non-impacting square drive torque tool.



Charging and data download via the netbook.

**Each set includes:**  
Smart Socket, Socket Retaining Pin and 'O' Ring, USB Charger / Comms. Cable, Software, and Operating Manual.  
Netbook and USB Mains Adaptor (optional) available at extra cost.

**HIRE, SALES & ADVICE**  
**01709 550088**

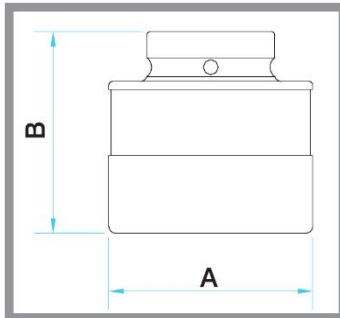

See table for dimensions and detail

Model	Drive Size	Torque Range (Nm)		Weight Kg	Dimensions (mm)	
		Min.	Max.		A	B
<b>33mm Smart Socket</b>	3/4"	200	2,000	1.2	72	100
<b>36mm Smart Socket</b>	1"	200	2,000	1.2	72	100
<b>41mm Smart Socket</b>	1"	200	2,000	1.2	72	87
<b>46mm Smart Socket</b>	1"	200	2,000	1.2	72	87
<b>50mm Smart Socket</b>	1"	400	4,000	1.5	86	85
<b>55mm Smart Socket</b>	1"	400	4,000	1.5	86	89
<b>60mm Smart Socket</b>	1"	400	4,600	1.5	86	89
<b>65mm Smart Socket</b>	1 1/2"	1,100	10,800	4.0	115	121
<b>70mm Smart Socket</b>	1 1/2"	1,100	10,800	4.0	115	121
<b>80mm Smart Socket</b>	1 1/2"	1,100	10,800	4.0	115	121
<b>90mm Smart Socket</b>	1 1/2"	1,600	16,000	5.8	115	130
<b>100mm Smart Socket</b>	1 1/2"	1,600	16,000	7.2	120	146